



HT5360系列 三相三线电源滤波器

- 低泄漏电流，用于对漏电流严格要求的场合
- 有效抑制设备本身对电网的电磁干扰
- 另有HT5360G系列用于预防电网中高频杂波对设备的干扰，避免造成误动作



| 型 号 | 额定电流 A | 连接方式 | | | 外壳 | 漏电流 mA @250VAC/50Hz |
|----------------------|-----------|--|--|---|------|---------------------------|
| | |  焊片 |  螺栓 |  铜排 | | |
| HT5360-6-M4-C31 | 6 | -- | M4 | -- | C31 | 1.2 |
| HT5360-6-L8-C31 | 6 | L8 | -- | -- | C31 | 1.2 |
| HT5360-8-M4-C31 | 8 | -- | M4 | -- | C31 | 1.2 |
| HT5360-8-L8-C31 | 8 | L8 | -- | -- | C31 | 1.2 |
| HT5360-10-M4-C31 | 10 | -- | M4 | -- | C31 | 2.5 |
| HT5360-10-L8-C31 | 10 | L8 | -- | -- | C31 | 2.5 |
| HT5360-13-M4-E32 | 13 | -- | M4 | -- | E32 | 2.5 |
| HT5360-13-L8-E32 | 13 | L8 | -- | -- | E32 | 2.5 |
| HT5360-16-M4-E32 | 16 | -- | M4 | -- | E32 | 2.5 |
| HT5360-16-L8-E32 | 16 | L8 | -- | -- | E32 | 2.5 |
| HT5360-20-M4-E32 | 20 | -- | M4 | -- | E32 | 2.5 |
| HT5360-20-L8-E32 | 20 | L8 | -- | -- | E32 | 2.5 |
| HT5360-25-M4-E32 | 25 | -- | M4 | -- | E32 | 2.5 |
| HT5360-32-M6-G32 | 32 | -- | M6 | -- | G32 | 5.1 |
| HT5360-42-M6-G32 | 42 | -- | M6 | -- | G32 | 5.1 |
| HT5360-50-M6-G33 | 50 | -- | M6 | -- | G33 | 5.1 |
| HT5360-65-M6-G33 | 65 | -- | M6 | -- | G33 | 5.1 |
| HT5360-80-M8-G35 | 80 | -- | M8 | -- | G35 | 5.1 |
| HT5360-100-M8-G35 | 100 | -- | M8 | -- | G35 | 11 |
| HT5360-120-M8-G35 | 120 | -- | M8 | -- | G35 | 11 |
| HT5360-150-M10-G36 | 150 | -- | M10 | -- | G36 | 11 |
| HT5360-180-M10-G36 | 180 | -- | M10 | -- | G36 | 11 |
| HT5360-250-Bar-Y5A | 250 | -- | -- | Bar | Y5A | 11 |
| HT5360-420-Bar-Y6A | 420 | -- | -- | Bar | Y6A | 11 |
| HT5360-630-Bar-Y7A | 630 | -- | -- | Bar | Y7A | 11 |
| HT5360-800-Bar-Y10A | 800 | -- | -- | Bar | Y10A | 11 |
| HT5360-1000-Bar-Y10A | 1000 | -- | -- | Bar | Y10A | 11 |

* 连接方式：L8-焊片（6.3*0.8）；M4-M4螺栓；M6-M6螺栓；M8-M8螺栓；M10-M10螺栓；Bar-铜排。



HUGETON
惠博顿

HT5360系列 变三相三线电源滤波器

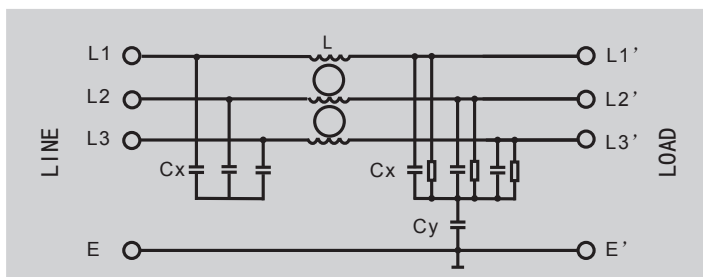

工作频率:50/60Hz
 额定电压:440VAC
 额定电流:6~1000A(50°C时),最大值
 耐压测试(2秒钟):
 2250VDC(L-L) 2700VDC(L-E)
 温度范围:-25°C~+100°C

插入损耗

符合IEC/CISPR NO.17

50Ω/50Ω共模: — 50Ω/50Ω差模: - - - - -

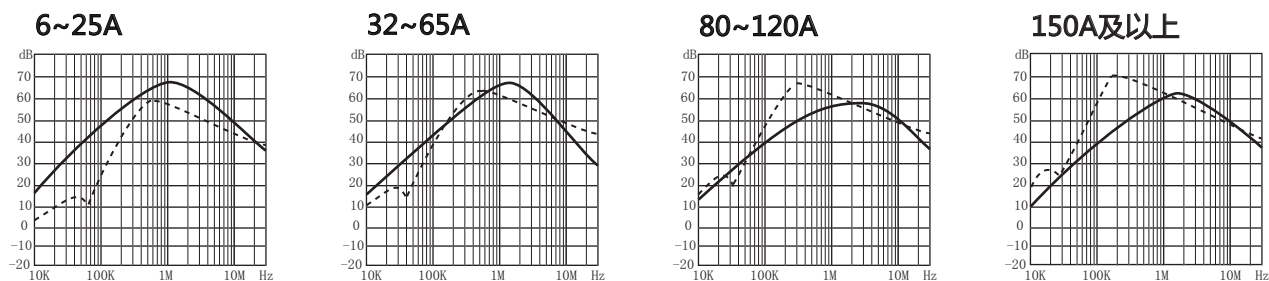

外形尺寸

单位: mm 公差: ±1

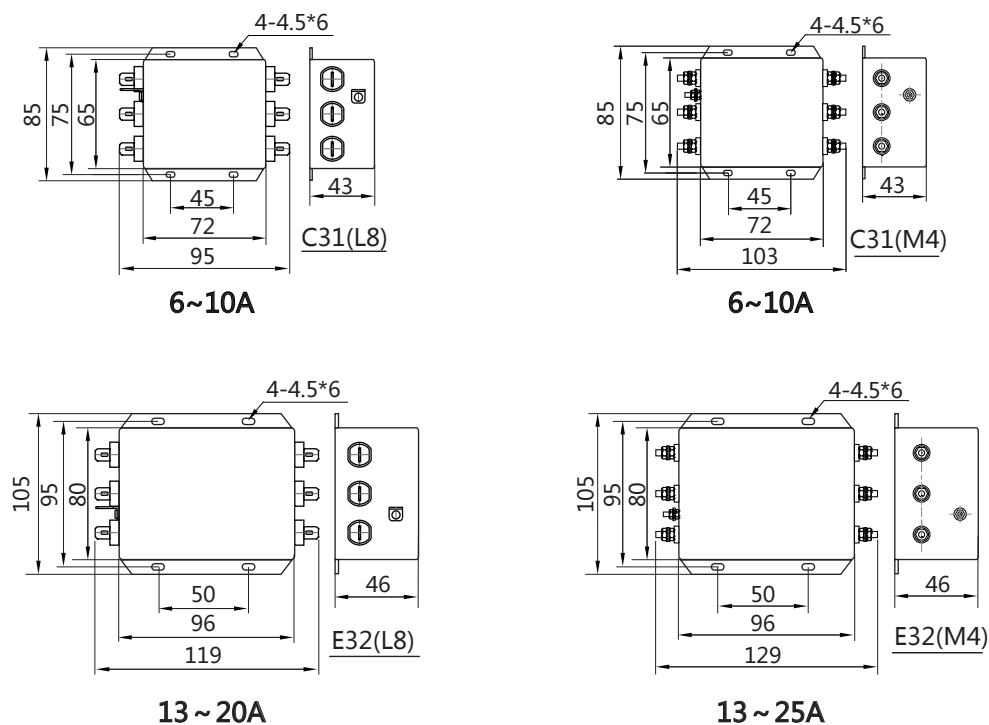



HUGETON

惠博顿

HT5360系列 三相三线电源滤波器

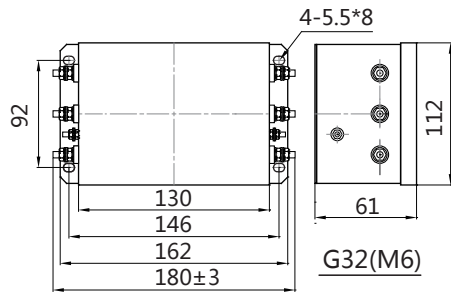

32 ~ 42A

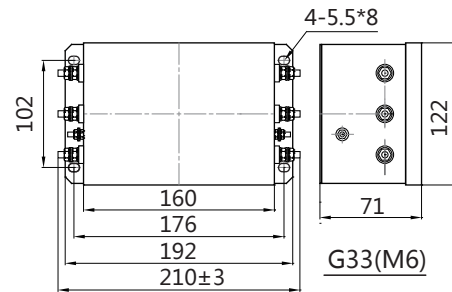

50 ~ 65A

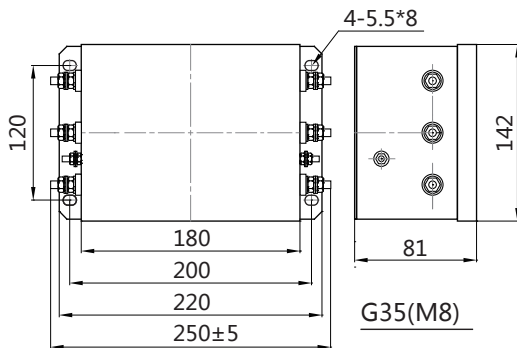

80 ~ 120A

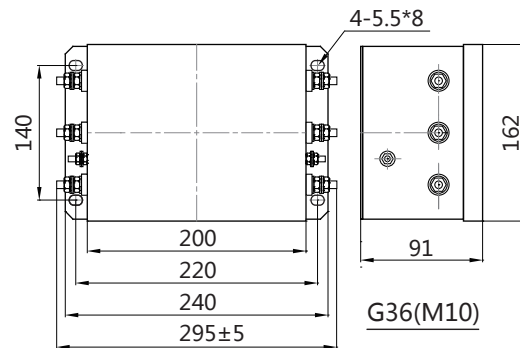

150A ~ 180A

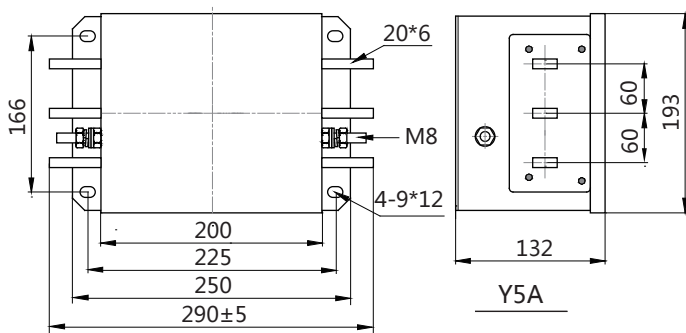

250A

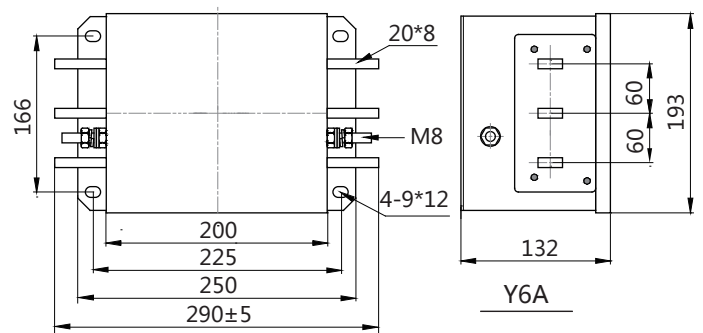

420A

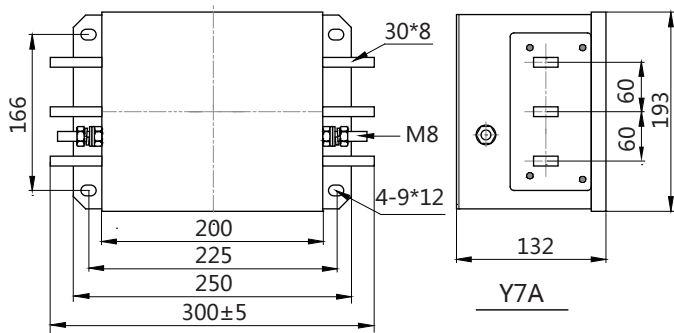

630A

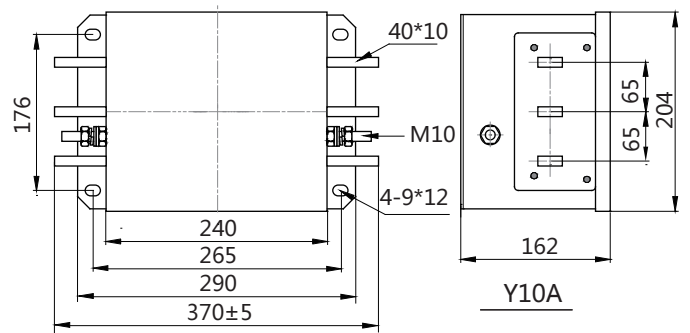

800 ~ 1000A